

CRUSE & ASSOCIATES

PROFESSIONAL LAND SURVEYORS

STILLWELL/BACKSTROM BLA DESCRIPTIONS
7/2/12



Backstrom New Description

The Northwest Quarter of the Northeast Quarter of Section 21, Township 19 North, Range 20 East, W.M., in the County of Kittitas, State of Washington;

AND Parcel B of that certain survey recorded June 5, 2012 in Book 38 of Surveys, page 19, under Auditor's File No. 201206050011, Records of Kittitas County, Washington; being a portion of the Southwest Quarter of the Northeast Quarter of Section 21, Township 19 North, Range 20 East, W.M., in the County of Kittitas, State of Washington;

EXCEPT Parcel A of that certain survey recorded June 5, 2012 in Book 38 of Surveys, page 19, under Auditor's File No. 201206050011, Records of Kittitas County, Washington; being a portion of the Northwest Quarter of the Northeast Quarter of Section 21, Township 19 North, Range 20 East, W.M., in the County of Kittitas, State of Washington.

Stillwell New Description

The Northeast Quarter of the Southwest Quarter of the Northeast Quarter of Section 21, Township 19 North, Range 20 East, W.M., in the County of Kittitas, State of Washington;

AND Parcel A of that certain survey recorded June 5, 2012 in Book 38 of Surveys, page 19, under Auditor's File No. 201206050011, Records of Kittitas County, Washington; being a portion of the Northwest Quarter of the Northeast Quarter of Section 21, Township 19 North, Range 20 East, W.M., in the County of Kittitas, State of Washington;

EXCEPT Parcel B of that certain survey recorded June 5, 2012 in Book 38 of Surveys, page 19, under Auditor's File No. 201206050011, Records of Kittitas County, Washington; being a portion of the Southwest Quarter of the Northeast Quarter of Section 21, Township 19 North, Range 20 East, W.M., in the County of Kittitas, State of Washington.

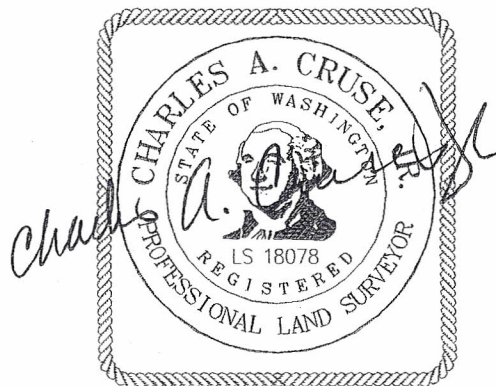

7-2-12

